

LEGENDA

- ////// Linie electrica aeriana 0.4 KV existenta
- TET Tablou electric turn breasla
- TEG Tablou electric general proiectat
- Linie electrica subterana cablu 0.4 KV
- Priza de pamant OL-Zn 40x4 mm
- Electrod OL-Zn D= 2/1/2" l=3.0m
- PS Piesa de separatie

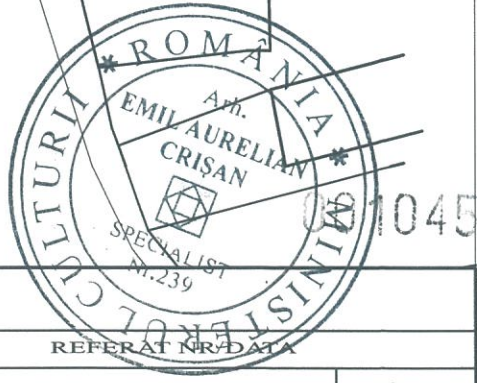

VERIFICATOR		NUME	SEMNTURA	CERINTA	REFERAT NR./DATA
PROVIDO P.F.A. F32/1693/2004 SIBIU, Bd. Victoriei, nr. 35 Tel/Fax 0269/214286, Tel 0766/416498		[Signature]		Beneficiar:	PAROHIA EVANGHELICA C.A. AGNITA
				Proiect	18/2016
SPECIFICATIE		NUME	SEMNTAT	SCARA	Faza
Sef proiect		arh E.A. Crisan	[Signature]	Sc. 1:500	P. Th.
Proiectat		ing V. Poclitaru	[Signature]	Data	Titlu plansa: Retele electrice exterioare Turnuri bresle
Proiectat		ing V. Poclitaru	[Signature]	02/2018	

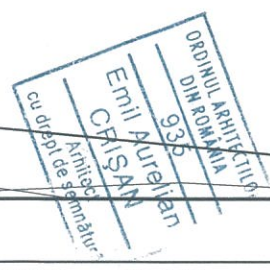

Plan cota +1.00

Legenda:

- × Corp de iluminat de siguranta
- × Corp de iluminat cu incandescenta
- ⌋ Priza cu contact de protectie
- ⊗ Corp de iluminat de exterior
- ⌋ Interruptor, comutator
- Circuit electric iluminat
- Circuit electric prize
- Circuit electric instalatii securitate
- ▭ Tablou electric



001046

PROVIDO PFA Sibiu, Bd Victoriei nr 35 Tel/Fax 0269/214286, Tel 0766/416498		Beneficiar: BISERICA EVANGHELICA C.A. AGNITA		Pr nr 18/2016
SEF PROIECT	arh E. CRISAN	Scara	Denumire proiect: Restaurarea ansamblului Bisericii Evanghelice C.A. Agnita	Faza PT
PROIECTAT	Ing V. POCLITARU	Data	Denumire plansa:	Plan nr
DESENAT	Ing V. POCLITARU	2018, Mar	Turnul Dogarilor - Instalatii electrice cota +1.00	-E202

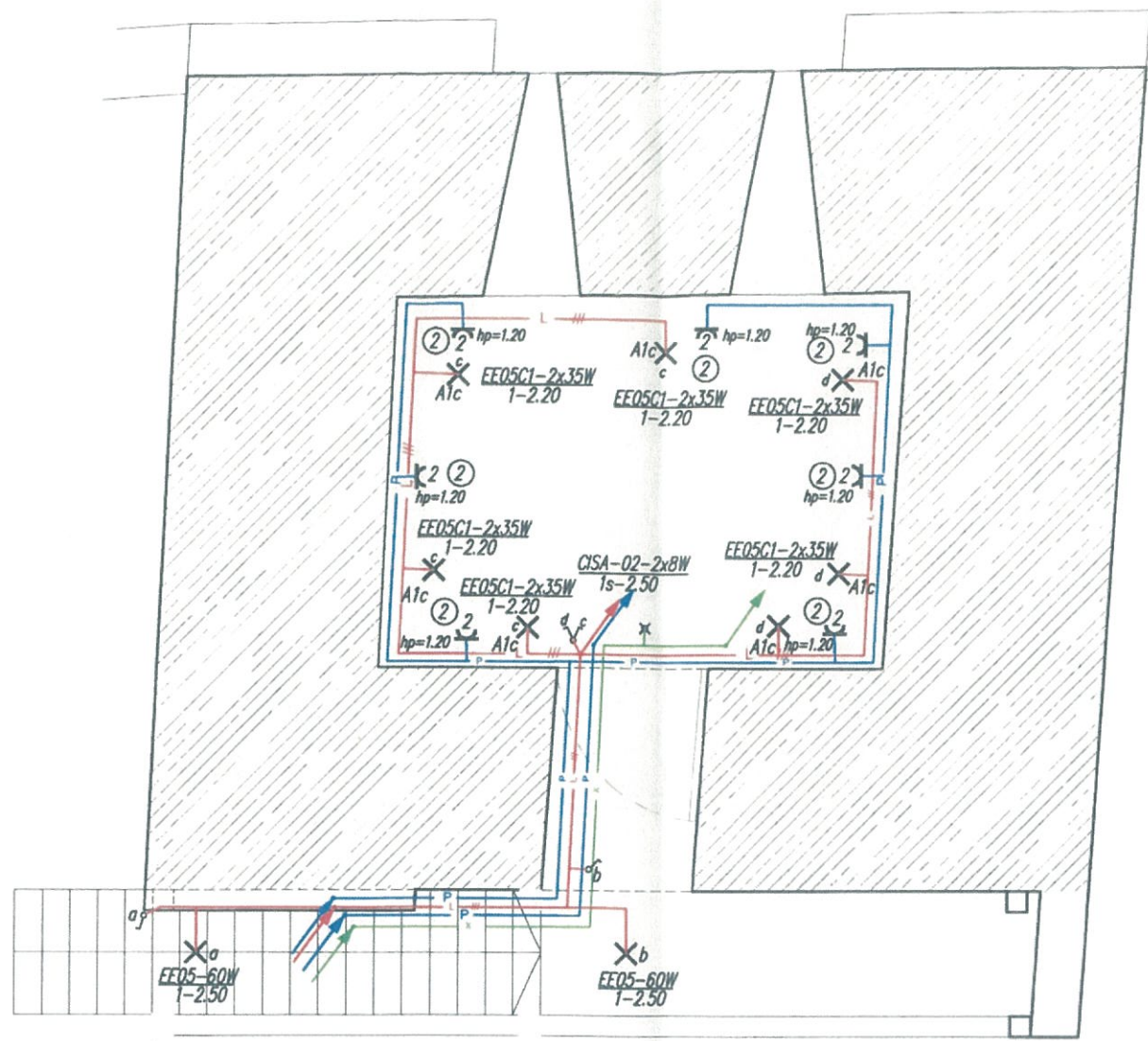

Plan cota +5.80

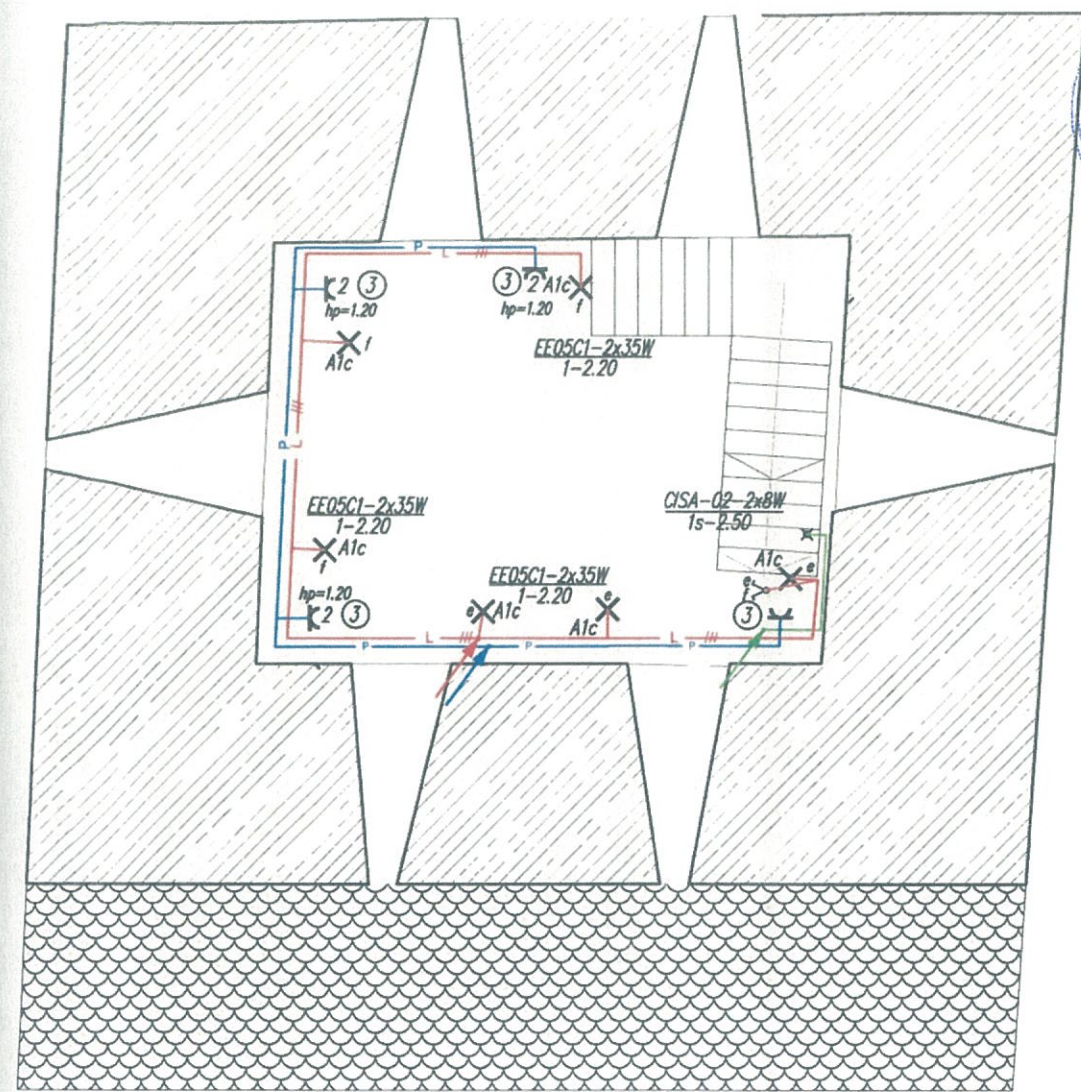

Plan cota +8.00

Legenda:

- ✕ Corp de iluminat de siguranta
- ✕ Corp de iluminat cu incandescenta
- ⌋ Priza cu contact de protectie
- ⊗ Corp de iluminat de exterior
- ⌋ Intreruptor, comutator
- L- Circuit electric iluminat
- P- Circuit electric prize
- X- Circuit electric instalatii securitate
- ▭ Tablou electric



001047

PROVIDO PPA Sibiu, Bd Victoriei nr 35 Tel/Fax 0269/214286, Tel 0766/416498			Beneficiar: BISERICA EVANGHELICA C.A. AGNITA	Pr nr 18/2016
SEF PROIECT	arh E. CRISAN	Semnatura	Scara 1:50	Denumire proiect: Restaurarea ansamblului Bisericii Evanghelice C.A. Agnita
PROIECTAT	Ing V. POCLITARU	Semnatura	Data 2018, Mar	Denumire plansa: Turnul Dogarilor - Instalatii electrice cota +5,80, +8,00
DESENAT	Ing V. POCLITARU	Semnatura		Plan nr -E203

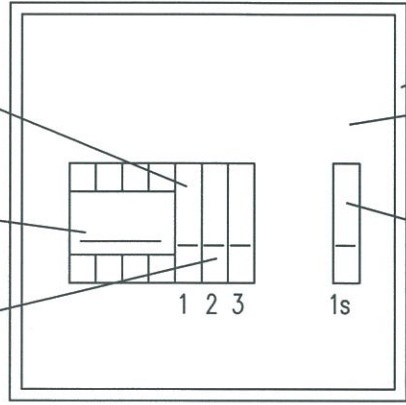
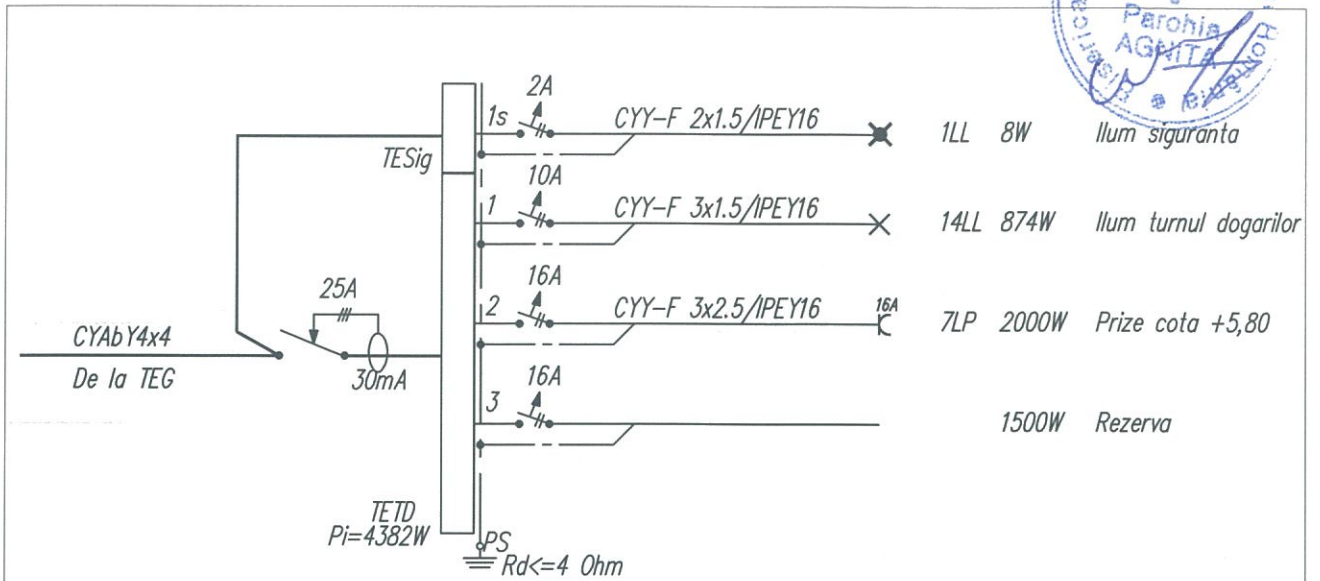

Legenda:

- Corp de iluminat de siguranta
- Corp de iluminat cu incandescenta
- Corp de iluminat cu fluorescanta
- Tablu electric
- Corp de iluminat tip plafoniera
- Priza monofaz. cu contact de protectie

Poz	Denumire	Caracteristici	Cod	Furnizor	Buc	Observatii
6	Interruptor aut curent diferential rezidual	230/400V 25A, 30mA	ID/RCCB Cod 23.068			
5	Interruptor automat monopolar	230V, 16A Curba B	DPNa Cod 19.123	Merlin Gerin		
4	Interruptor automat monopolar	230V, 10A Curba B	DPNa Cod 19.121	Merlin Gerin		
3	Interruptor automat monopolar	230V, 2A 1P+N	DPN N Cod 21.553	Merlin Gerin		
2	Placa de montaj perforata	265x250	MR-33	Schneider Electric		
1	Cofret metalic monobloc	300x300x150	CRN-33/150	Schneider Electric		

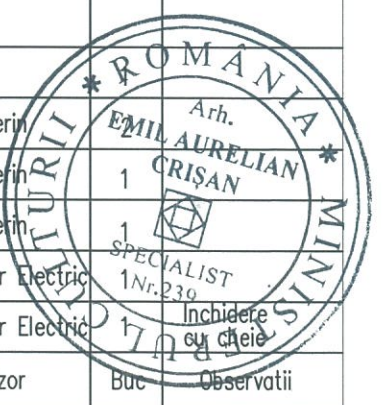

PROVIDO Sibiu, Bd Victoriei nr 1351 21368499 Tel/Fax 0269/214286, Tel 0766416493		BISERICA EVANGHELICA C.A. AGNITA Beneficiar: Emil Aurelian CRISAN		Pr nr 18/2016
SEF PROIECT	arh E.CRISAN	Scara	Restaurarea ansamblului Bisericii Evanghelice C.A. Agnita	Faza PT
PROIECTAT	Ing V. POCLITARU	Data	Denumire plansa:	Plan nr
DESENAT	Ing V. POCLITARU	2018, Mar	Schema si tablou electric Turnul Dogarilor TETD	-E204

001048